

# ACOUSTIC DOOR

## AS-45-SPECIAL-E

**TECH SHEET**—AS-45-SPECIAL-E

Issue: 13-12-04

**2 hr fire rated 45 Rw single acoustic / smoke / fire door**

### DESCRIPTION

Pyropanel AS-45-SPECIAL is a 45 Rw, non fire rated 48mm single leaf acoustic door that utilises a Pyropanel Euroseal® perimeter smoke / acoustic seal and a Pyropanel 'Pyrosill' bottom seal. This door comes standard with steel faces, and can be upgraded to ballistic rating as tested to Australian Standards.

### APPLICATIONS

Ideal for applications that require no fire resistance but require smoke resistance and an acoustic rating of 45 Rw. Are also very suitable when certified bullet resistance is required.

### FEATURES

#### Acoustic Rating

- 45 Rw (45 STC)

#### Test Certificate number

- TL409(r)

#### Fire Resistance

- Nil

#### Door Configuration

- Single leaf hung in a steel frame

#### Perimeter Seal

- Pyropanel Euroseal® smoke / acoustic perimeter seal

#### Bottom Seal

- Pyropanel 'Pyrosill' sill seal

#### Thickness

- 48mm (Nominal)

#### Size

- Maximum Size - 2400 x 1200

#### Hinges

- Minimum 4 heavy duty steel hinges

#### Frame

- Packed pressed metal frame (2 hr)

#### Finish

- Steel to both faces

### OPTIONAL EXTRAS

- Ballistic rating to G0, G1, G2, S0 and S1 (tested to Australian Standards).
- Pre-hung in steel frame
- Ply, MDF, Veneer or Laminate facings can be applied over existing steel faces.
- Stainless steel faces
- Vision panels - 300 x 200 or 250 x 250mm.
- Kick Panels of 1.2mm Stainless Steel to selected height
- Meets the BCA requirement for a smoke door.

### INSTALLATION

This door is extremely heavy, and the frame must be securely attached to the wall structure. Frame must then be tightly sealed to the wall structure using Pyropanel Multiflex or approved alternative fire and acoustic sealant. Metal door frames will require packing with Pyropanel FR board, Fire rated plaster, concrete or mortar to achieve desired acoustic and fire rating.

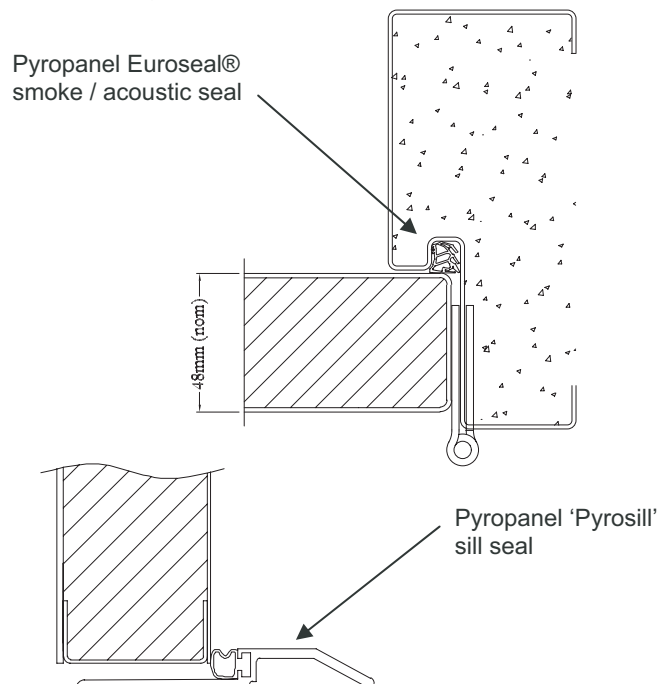

### HOW TO SPECIFY

*"Door to be a Pyropanel AS-45-SPECIAL acoustic door with Bullet resistance \* installed in a packed pressed metal door frame\*"*

\* denotes example—delete, change or specify as required



**UNITED DOORMAKERS**

Melba Industrial Park, Factory 2,  
122-124 Beresford Road, Lilydale,  
Victoria 3140, Australia.

T: +61 3 9735 3911 F: +61 3 9735 5411

W: [www.udm.com.au](http://www.udm.com.au) E: [sales@udm.com.au](mailto:sales@udm.com.au)

Part of the

**PYRO PANEL**

Group