

ACOUSTIC DOOR

AS-36-PYROL-E

TECH SHEET—AS-36-PYROL-E

Issue: 13-12-04

Non fire rated 36 Rw single acoustic / smoke door

DESCRIPTION

Pyropanel AS-36-PYROL is a 36 STC / Rw non fire rated 48mm single leaf acoustic door that utilises a Pyropanel Euroseal® concealed perimeter smoke / acoustic seal and a Pyropanel 'Pyrosill' sill seal. This door comes standard with LP-design metal facings

APPLICATIONS

Ideal applications that require no fire resistance, but require smoke resistance and an acoustic rating of 36 Rw, such as smoke doors in hospitals, schools and offices.

FEATURES

Acoustic Rating

- 36 Rw (32 STC)

Test Certificate number

- TL409(m)

Fire Resistance

- Nil

Door Configuration

- Single leaf hung in a timber or steel frame

Perimeter Seal

- Pyropanel Euroseal® concealed smoke / acoustic seal

Bottom Seal

- Pyropanel 'Pyrosill' sill seal

Thickness

- 48mm (Nominal)

Size

- Maximum Size - 2400 x 1200

Hinges

- Minimum 3 steel hinges

Frame

- Timber or packed pressed metal frame

Finish

- Metal facings (LP design)

OPTIONAL EXTRAS

- Pre-hung in timber or steel frame
- Veneer or Laminate facings can be applied over ply face
- Stainless steel face
- Vision panels - 300 x 200 or 250 x 250mm.
- Kick Panels of 1.2mm Stainless Steel to selected height
- Meets the BCA requirement for a smoke door.

INSTALLATION

Door frame must be tightly sealed against wall structure using Pyropanel Multiflex or approved alternative fire and acoustic sealant. Metal door frames will require packing with Pyropanel FR board, Fire rated plaster, concrete or mortar to achieve desired acoustic and fire rating.

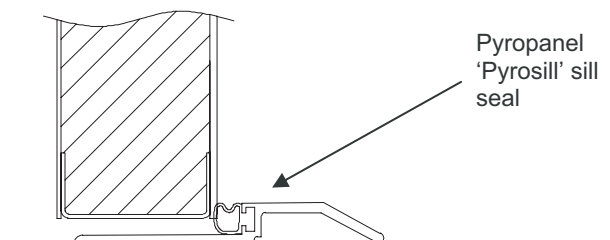
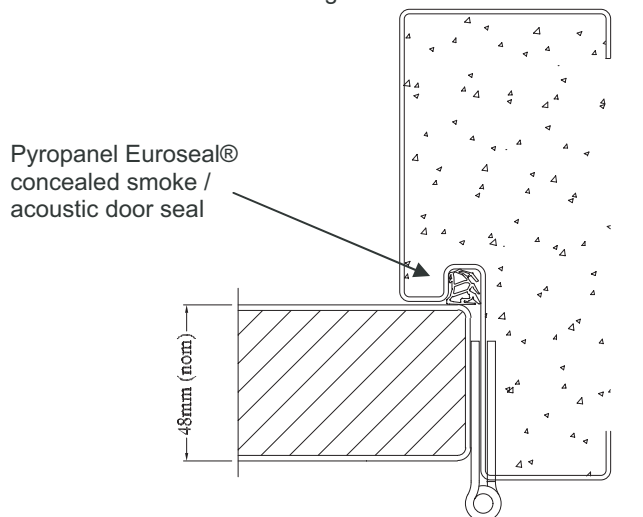

HOW TO SPECIFY

"Door to be a Pyropanel AS-36-PYROL-E acoustic door installed into a timber or packed metal door frame*"*

* denotes example—delete, change or specify as required



UNITED DOORMAKERS

Melba Industrial Park, Factory 2,
122-124 Beresford Road, Lilydale,
Victoria 3140, Australia.

T: +61 3 9735 3911 F: +61 3 9735 5411

W: www.udm.com.au E: sales@udm.com.au

Part of the

PYRO PANEL

Group